

GA6 Long Body Compartment Lock With 90° Key Removal

Features

- With extended body depth to 30 mm, these locks are ideal for thick panels (chipboard, composites)
- Keys can be withdrawn in locked and unlocked positions with both 90° and 180° models
- Locks have 'shuttered' keyway for weather protection, with spiked locating plate and straight cam pawl
- Keyway is oriented to 45° to 'flats' on body: adjust panel-piercing to compensate or use round hole with spiked locating plate

Material

- Steel, chromium plated

Notes

- 'FS' keys as standard with 'shuttered' keyway. Optionally 'FT', '92' or 'DLP' key types also available
- Cam pawl can be fitted at 45° intervals
- Wide choice of cam pawls, finish options and accessory items available

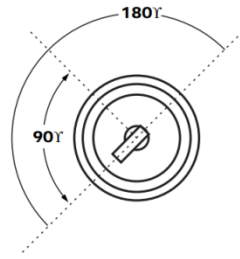
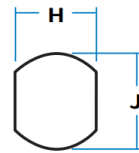
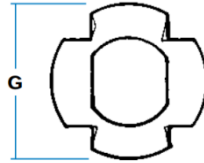

Offset aperture by 45° to compensate for orientation of keyway

For clarity, retaining nut is not shown



G01905
(Spiked locating plate)



GA6-G00589

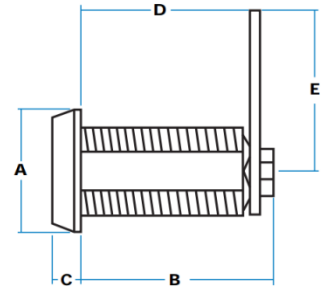

Part No.	Rotation	Key Type	A	B	C	D	E	G	H	J
GA6-G00589	90°	Mixed	26	35	8	30	35	34	17.5	20
GA6-G00589-01		FS880								
GA6-G00590	180°	Mixed								
GA6-G00590-01		FS880								

GA6 Weathershield Locks

Features

- A special model, with pivoted die cast cover which protects keyway against dust and water
- Normally 90° operation with key withdrawing in both positions

Material

- Steel, chromium plated

Notes

- A special piercing is required. Die cast spacer is provided for fitting above or below panel surface as required
- Special cam pawl **G08995** fits at 90° intervals

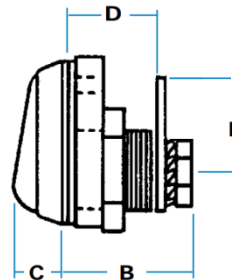
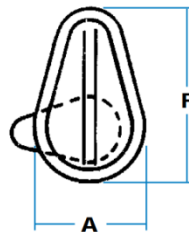

GA6-G08996

Part No.	Opening	Key Type	A	B	C	D	E	F
GA6-G08996	90°	FS	25	27	12	19	20	38
GA6-G-8996-01		FS880						
GA6-G00849		FT						